



900 Series Syringe Barrels

Metcal syringe barrels are comprised of industry-compliant silicone and chloride-free, low-friction polypropylene. Available in three colors: Natural for most generic applications, Amber for protection against UV/visible light, blocking up to 520nm, but providing the ability to see the fluid inside the barrel, and Black for total light blocking. Five sizes are available: 3 cc, 5 cc, 10 cc, 30 cc, and 55 cc. Made from polypropylene. Up to 100psi (6.9bar) operating pressure.

900 Series Syringe Barrels

Data Sheet



DIMENSIONS

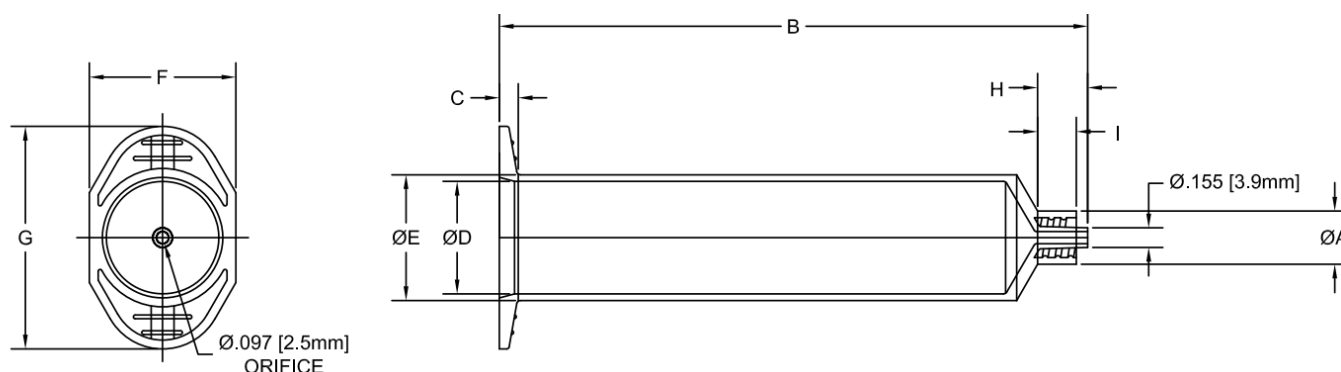

Diagram not to scale | Dimensions are for reference only

PART NO.	SIZE	COLOR	DIMENSIONS (IN [mm])							
			B	C	D (ID)	E	F	G	H	I
903-N	3 cc	CLEAR	2.96 [75.2]	.16 [4.1]	.375 [9.53]	.455 [11.56]	.56 [14.2]	1.24 [31.5]	.45 [11.3]	.355 [9.02]
903-B	3 cc	BLACK								
903-D	3 cc	AMBER								
905-N	5 cc	CLEAR	2.83 [71.9]	.14 [3.6]	.500 [12.70]	.594 [15.09]	.74 [18.7]	1.24 [31.5]	.43 [10.8]	.335 [8.51]
905-B	5 cc	BLACK								
905-D	5 cc	AMBER								
910-N	10 cc	CLEAR	3.58 [90.9]	.13 [3.3]	.619 [15.72]	.719 [18.26]	.89 [22.6]	1.34 [34.0]	.41 [10.4]	.322 [8.18]
910-B	10 cc	BLACK								
910-D	10 cc	AMBER								
930-N	30 cc	CLEAR	4.66 [118.4]	.15 [3.8]	.890 [22.61]	.990 [25.15]	1.16 [29.5]	1.76 [44.7]	.41 [10.4]	.324 [8.23]
930-B	30 cc	BLACK								
930-D	30 cc	AMBER								
955-N	55 cc	CLEAR	6.91 [175.5]	.15 [3.8]	.890 [22.61]	1.01 [25.65]	1.16 [29.5]	1.76 [44.7]	.41 [10.4]	.360 [9.14]
955-B	55 cc	BLACK								
955-D	55 cc	AMBER								

**For Sales
and Support:**

Metcal Corporate Headquarters
10800 Valley View Street,
Cypress, California, 90630, USA
Tel: 1-714-799-9910
Fax: 1-714-828-2001
E-mail: eorders@okinternational.com

Visit our website for more information and to contact the Metcal office nearest you.

metcal.com/contact-us

